

TIRE DRESSING APPLICATOR, MODEL TB3-CUS999

**PUSH BAR AND DRIVER SIDE ARMS SAME LENGTH AS FOR PASSENGER SIDE
FOR DUAL BELT CONVEYOR**

The AVW Stainless Steel **Tire Dressing Applicator** is low profile, Accommodates varying width vehicles . Supplied with high density cloth applicator, retract kit, electric drive and dressing manifold with Dual pump Panel.

- Heavy Duty Stainless Steel
- Nickel Plated Bearings
 - Low Profile
 - 100'' lg-Brush
 - Hydraulic Drive
- UHMW –Covered Tire Contact Points
 - Adjustable Height
- UHMW Tire Contact Points

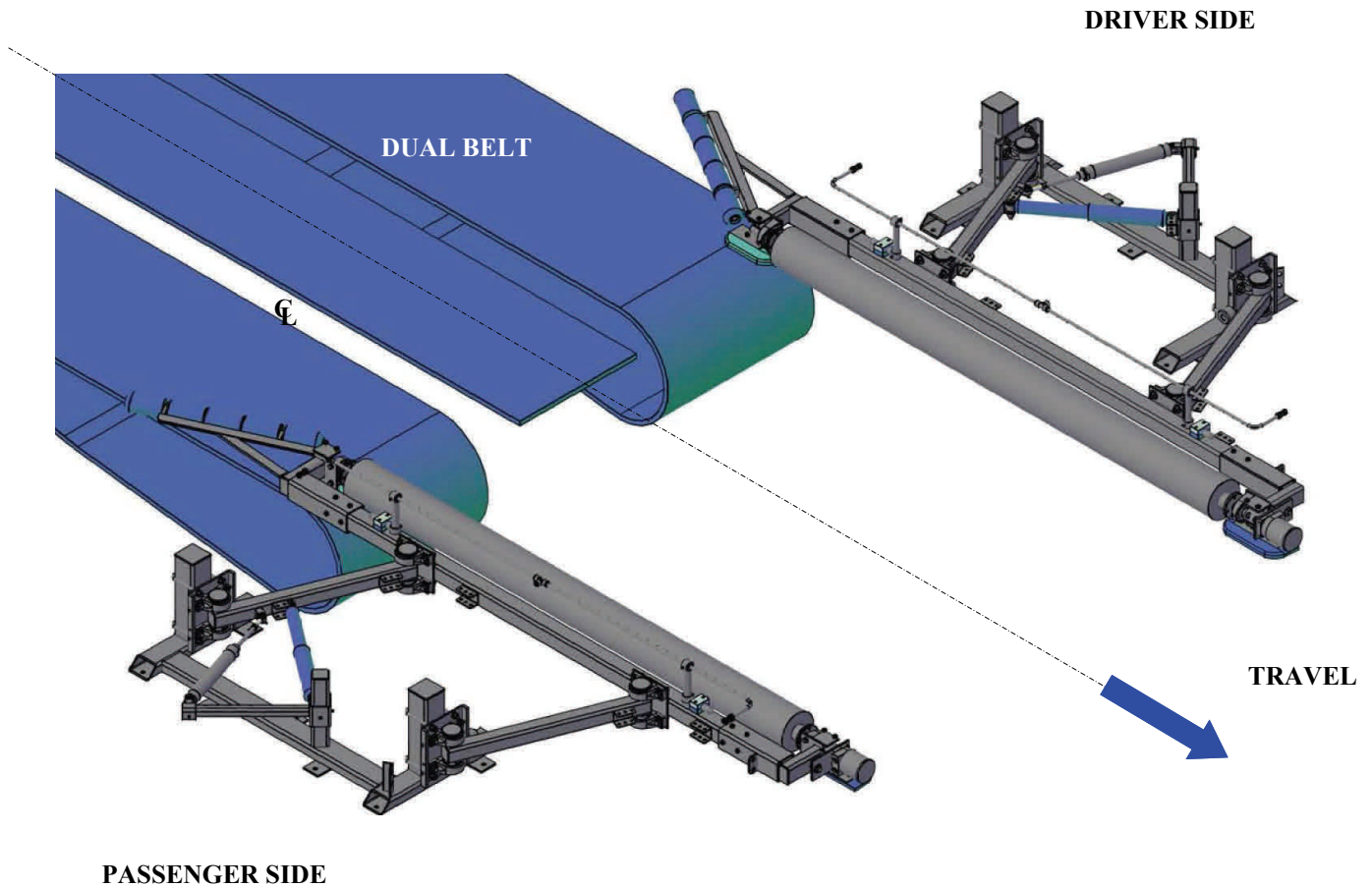

TIRE DRESSING APPLICATOR, MODEL TB3-CUS999

PUSH BAR AND DRIVER SIDE ARMS SAME LENGTH AS FOR PASSENGER SIDE
FOR DUAL BELT CONVEYOR

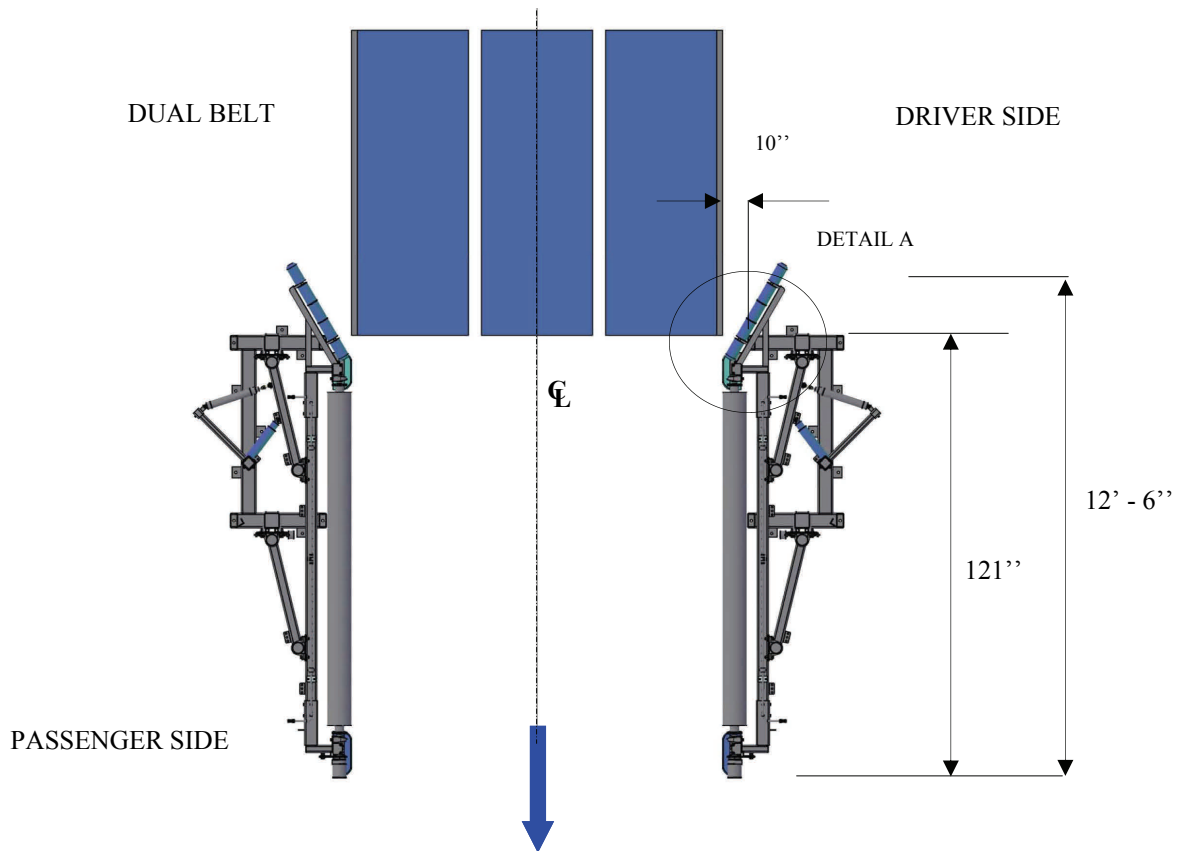

MOUNTING OF FRAME:

The Applicator needs to be in the retracted position and lined with the outer stainless belt guides. This will position the frame for anchoring.

For accuracy when the applicator is energized it should remain parallel with conveyor belt.



TIRE DRESSING APPLICATOR, MODEL TB3-CUS999

DETAIL - A

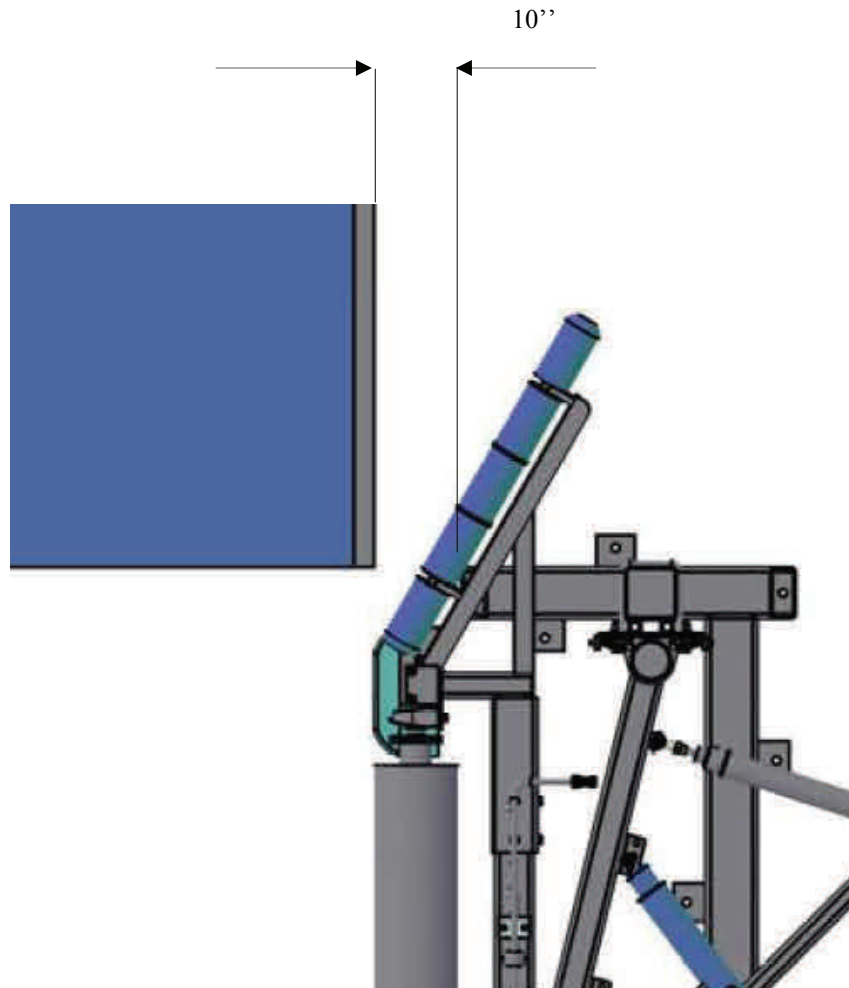

RPM: 60-80 RPM

Maintenance: Grease bearings weekly.

Height Adjustment: To adjust the height, loosen the bolts on bearings at base mount and adjust left or right for up & down movement of brush. When desired height is found, tighten all bolts.



TIRE DRESSING APPLICATOR, MODEL TB3-CUS999

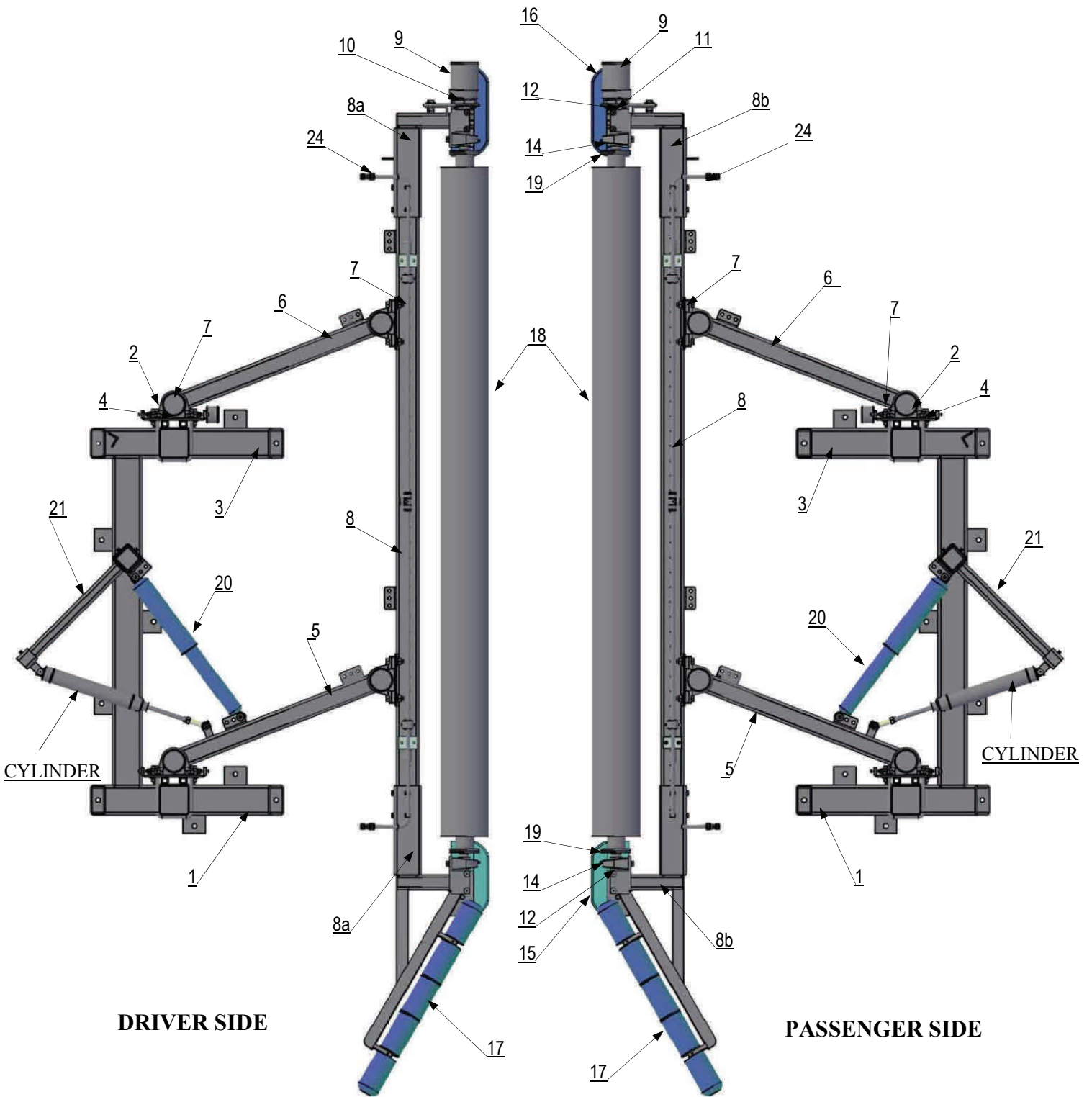

PUSH BAR AND DRIVER SIDE ARMS SAME LENGTH AS FOR PASSENGER SIDE



TIRE DRESSING APPLICATOR, MODEL TB3-CUS999

PUSH BAR AND DRIVER SIDE ARMS SAME LENGTH AS FOR PASSENGER SIDE

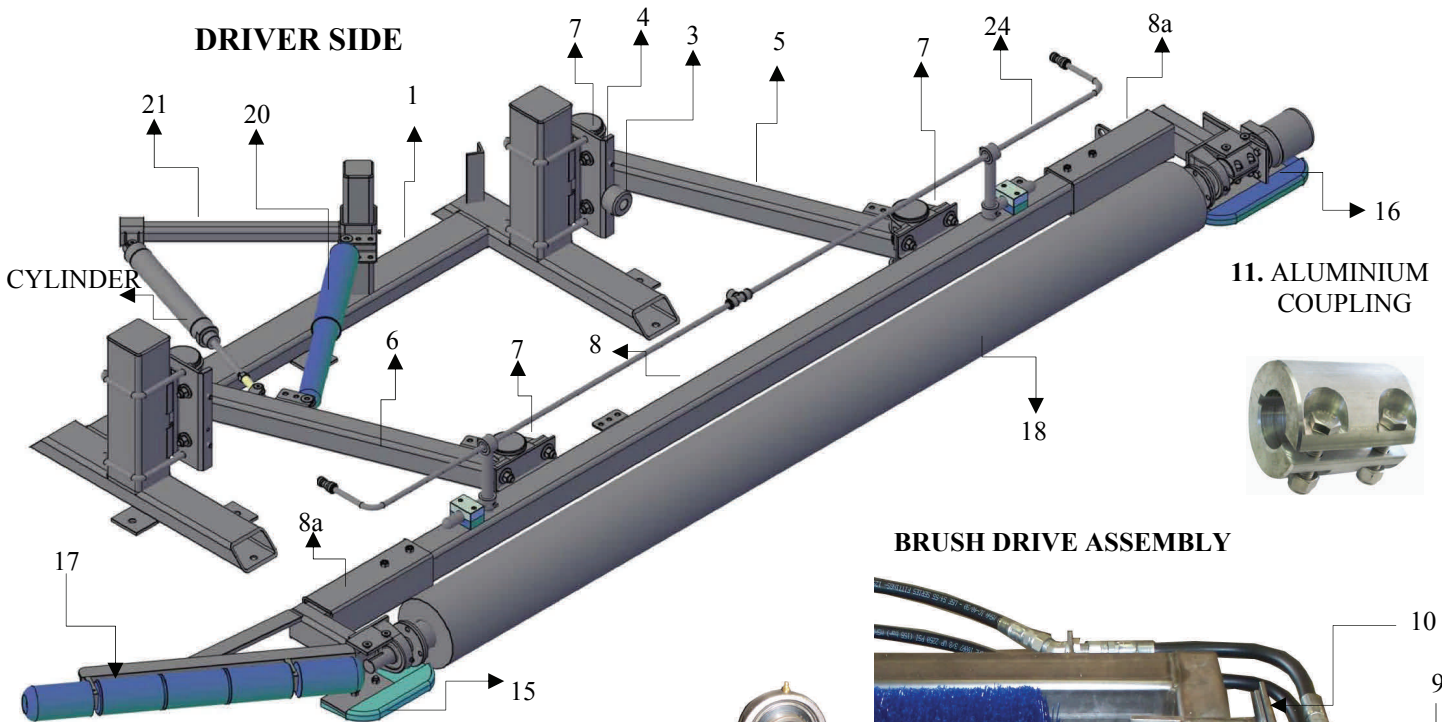

11. ALUMINIUM COUPLING



BRUSH DRIVE ASSEMBLY

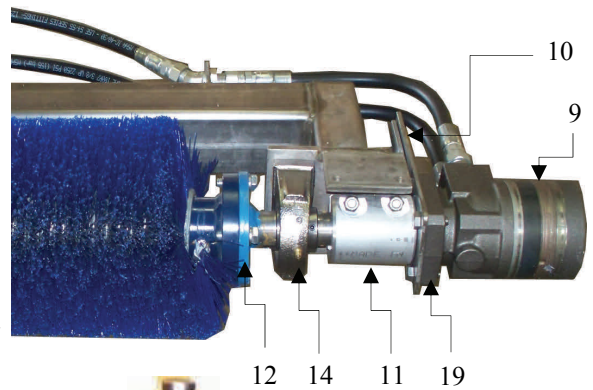

7. PILLOW BLOCK

10. TORQUE PLATE



12. DRIVE SHAFT



14. TAPPED BASE BEARING

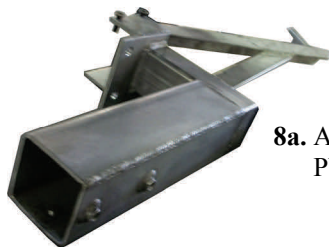

8a. ADJUSTABLE PUSH BAR

15. DRIVER SIDE:
-EXIT COVER -REAR
-ENTRANCE COVER- FRONT

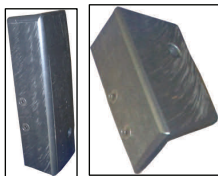

16. PASSENGER SIDE:
-EXIT COVER -REAR
-ENTRANCE COVER- FRONT

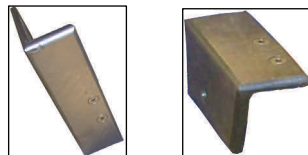

17a. ROLLER GUIDE SET—PASSENGER SIDE

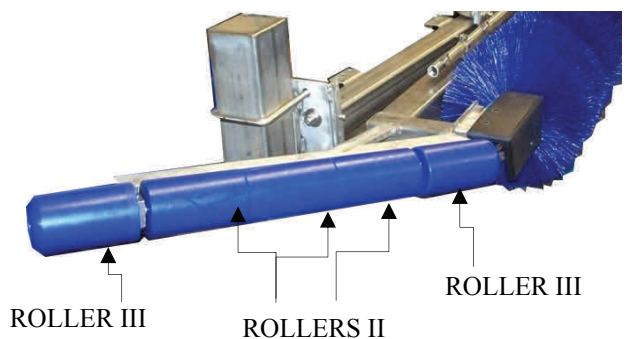
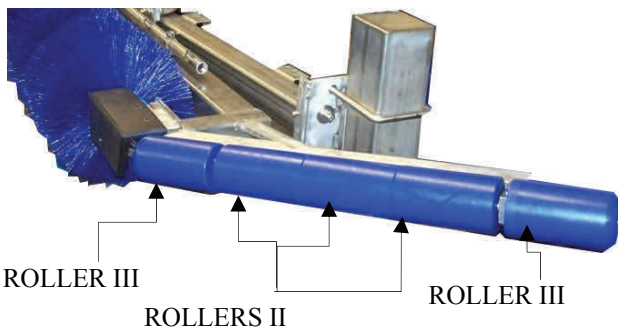

17. ROLLER GUIDE SET—DRIVER SIDE



TIRE DRESSING APPLICATOR, MODEL TB3-CUS999

PUSH BAR AND DRIVER SIDE ARMS SAME LENGTH AS FOR PASSENGER SIDE

SHOCK ABSORBER ASSEMBLY



20. SHOCK ABSORBER

PIN



COLLAR



20.1 MOUNTING ARM



21. TIRE WASHER RETRACT KIT

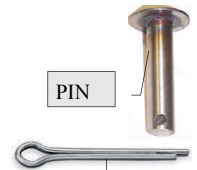
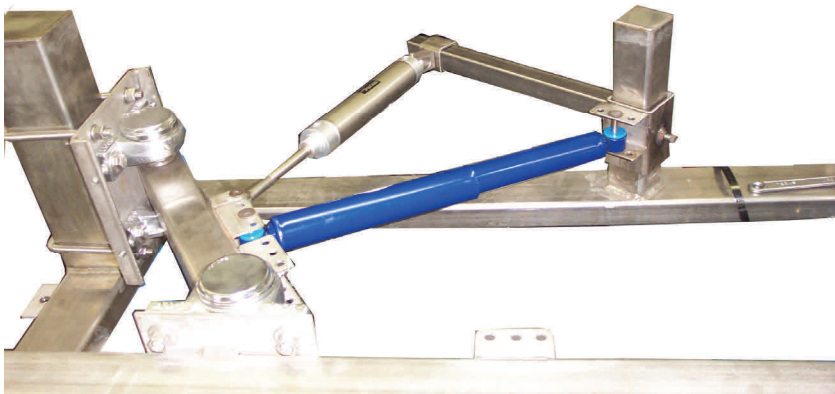

PIN

COTTER PIN

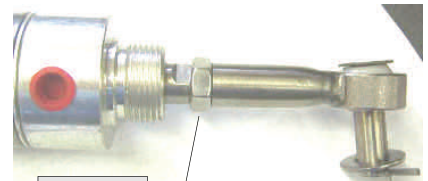

JAM NUT

REAR MOUNT for AIR CYLINDER

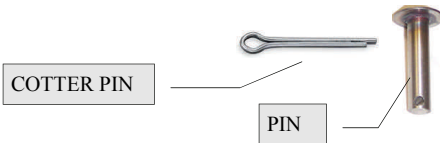

COTTER PIN

PIN

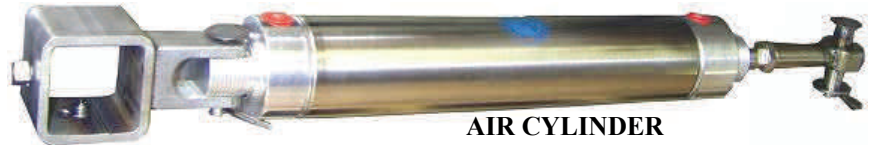

AIR CYLINDER

AIR CONTROL
PANEL



TIRE DRESSING APPLICATOR, MODEL TB3-CUS999

PUSH BAR AND DRIVER SIDE ARMS SAME LENGTH AS FOR PASSENGER SIDE

APPLICATION MANIFOLD ASSEMBLY

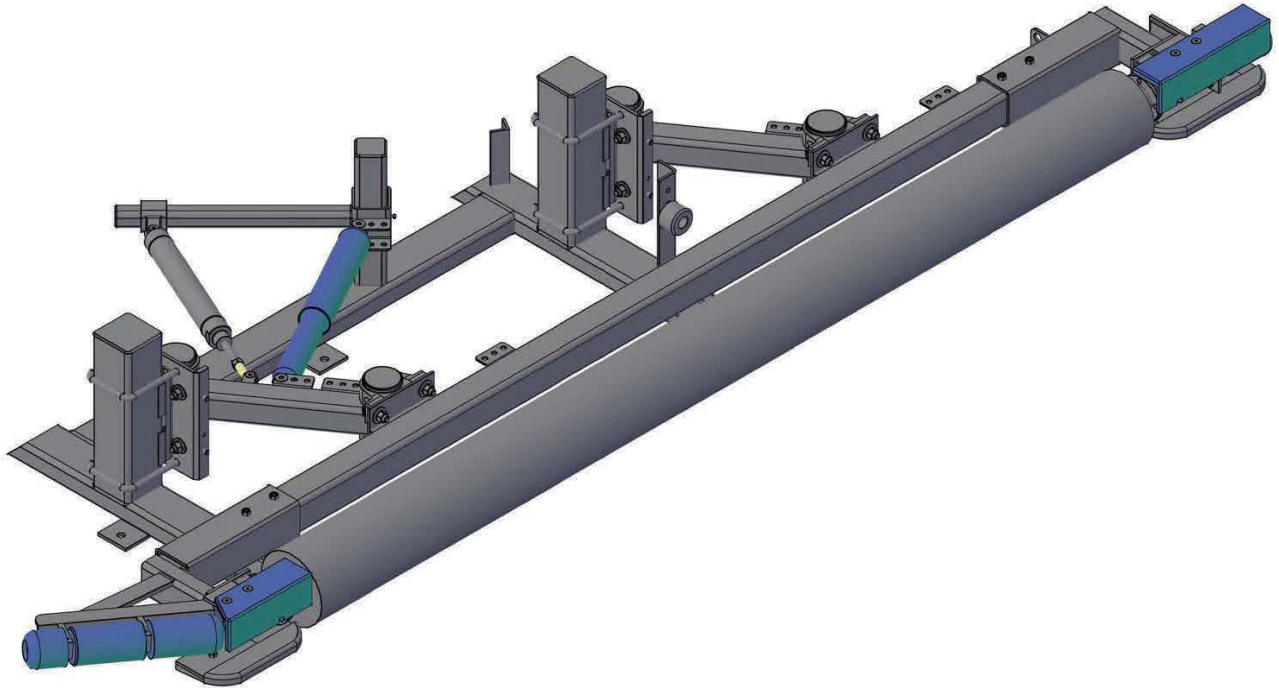

23. APPLICATION MANIFOLD ASSEMBLY



23.1 CLAMP



TIRE DRESSING APPLICATOR, MODEL TB3-CUS999

PUSH BAR AND DRIVER SIDE ARMS SAME LENGTH AS FOR PASSENGER SIDE

ITEM	Description	DRIVER SIDE		PASSENGER SIDE	
		PART NO.	Qty	PART NO.	Qty
-	TIRE BRUSH SIDE	TB2A	1	TB2B	1
-	FRAME ASSEMBLY	TB2AA	1	TB2BA	1
1	FRAME """"	TB2AAA	1	TB2BAA	1
2	HEX HEAD CAP SCREW 3/8''-16x2''LG Fully Threaded (for pillow block adjustment)	HHCS3816200F	8	HHCS3816200F	8
3	RUBBER STOP	WA1DBB	1	WA1DBB	1
-	Screw Fastener Set for Rubber Stop:	-	1	-	1
-	Hex Head Cap Screw 3/8''-16x2''LG	HHCS3816200F	1	HHCS3816200F	1
-	Flat Washer 3/8''I.D.x7/8''O.D	FW38087	1	FW38087	1
-	Hex Nut 3/8''-16	HN3816	1	HN3816	1
4	PILLOW BLOCK MOUNTING PLATE	TB2AAC	2	TB2AAC	2
-	Mounting Plate	TB2AACA	2	TB2AACA	2
-	Square U-Bolt Fastener Set 1/2''	RB2ABB	4	RB2ABB	4
-	Square U-Bolt 1/2''x17''LG	UB-SQ050x17	4	UB-SQ050x17	4
-	Split Lock Washer 1/2''	SLW1/2	8	SLW1/2	8
-	Hex Nut 1/2''-13	HN1213	8	HN1213	8
5	FRONT ARM	TB3ABX32	1	TB2BBX32	1
6	REAR ARM	TB3ACX32	1	TB2BCX32	1
7	PILLOW BLOCK BEARINGS 1-1/4'' (Capped)	TB1WB	4	TB1WB	4
-	Cap	TB1WC	4	TB1WC	4
-	Pillow Block Bearings (Non Capped)	RB1WB	4	RB1WB	4
-	Screw Fastener Set for Rubber Stop:	-	8	-	8
-	Hex Head Cap Screw 1/2''-13x2-1/4''LG	HHCS1213225	16	HHCS1213225	16
-	Flat Washer 1/2''I.D.x1-1/4''O.D	FW12125	32	FW12125	32
-	Hex Nut 1/2''-16	HN1216	16	HN1216	16
-	BRUSH -RACK SUPPORT FRAME ASSEMBLY:	TB3AD-4B-0810	1	TB3BD-4B-0810	1
8	BRUSH SUPPORT FRAME- (RACK)	TB3ADA-4B-0810	1	TB3BDA-4B-0810	1
-	- FRAME	TB3ADAA-4B-0810	1	TB3BDAA-4B-0810	1
8.1	PUSH BAR ASSEMBLY	TB3ADC-0810	1	TB3BDC-0810	1
8a	- ADJUSTABLE PUSH BAR	TB3ADABA-4B-0810	1	TB3BDABA-4B-0810	1
-	BRUSH DRIVE ASSEMBLY (4-Bolt spindle Des.)	TB3ADB-4B-CUS999	1	TB3ADB-4B-CUS999	1
9	HYDRAULIC MOTOR, Displacement 11.9(cu.inrev.)	WA1KM	1	WA1KM	1
-	Straight Fitting 1/2'' NPTMx1/2''JIC	SAE070102-8-8	2	SAE070102-8-8	2
10	TORQUE PLATE	TB2ADB1-4B	1	TB2ADB1-4B	1
-	Screw Fastener Set: 3/8''-16x3/4''lg (for Torque)	-	2	-	2



TIRE DRESSING APPLICATOR, MODEL TB3-CUS999

PUSH BAR AND DRIVER SIDE ARMS SAME LENGTH AS FOR PASSENGER SIDE

ITEM	Description	DRIVER SIDE		PASSENGER SIDE	
		PART NO.	Qty	PART NO.	Qty
11	ALUMINIUM COUPLING 1'' x 1-1/4''	TB1ADBC	1	TB1ADBC	1
12	DRIVE SHAFT Ø 1-1/4''x6''LG - (4-Bolt Design): SOCKET HEAD CAP SCREW (w/flat head) 3/8-16x1''LG	TB1AD1-4B	2	TB1AD1-4B	2
		SHCS3816100F	8	SHCS3816100F	8
14	TAPPED BASE BEARING 1-14'' - Screw Fastener Set for Bearing: - Hex Head Cap Screw 7/16''-14x3/4''LG - Split Lock Washer 7/16''	TB1ADDA	2	TB1ADDA	2
		-	4	-	4
		HHCS71614075	4	HHCS71614075	4
		SLW7/16	4	SLW7/16	4
15	ENTRANCE COVER (FRONT)	TB2AD2-0809-EL	1	TB2BD2-0809-EL	1
15a	Bumper Front, 10''LG	TB2AD2	1	TB2BD2	1
16	EXIT COVER (REAR)	TB2AD3-0809	1	TB2BD3-0809	1
16a	Bumper Rear, 12'' LG	TB2AD3	1	TB2BD3	1
-	CARRIAGE BOLT 3/8''-16x1-1/4''LG	CBS3816125	4	CBS3816125	4
-	HEX NUT 3/8''	HN3816	4	HN3816	4
17	ROLLER GUIDE SET (PUSH BAR) - Roller I (Dia. 3''x3''LG) - Roller II (Dia. 3''x5-5/8''LG) - Roller III (Dia. 3''x5-5/8''LG) - Collars 3/4''O.D. x 1-1/4''O.D. x 7/8W Shaft (Dia. 3/4''x14-1/2''LG)	TB1ADC	1	TB1BDC	1
		TB1ADC1-0209	1	-	-
		TB1ADC2-0209	1	TB1ADC2-0209	3
		TB1ADC3-0209	1	TB1ADC3-0209	2
		VD3L-34x125	2	VD3L-34x125	2
		TB1ADC4-0209	1	TB1BDC4-0209	1
-	BRUSH SET	TB1ADE-4B-94-CUS999	1	TB1ADE-4B-94-CUS999	1
18	BRUSH Ø8''x100''LG	TB1ADEA-4B-100-CUS999	1	TB1ADEA-4B-100-CUS999	1
19	4-BOLT SPINDLE	TB1ADEB-4B	2	TB1ADEB-4B	2
-	SHOCK ABSORBER ASSEMBLY:	TB1AE	1	TB1AE	1
20	SHOCK ABSORBER	WA1FAA	1	WA1FAA	1
-	SHOCK ABSORBER'S MOUNTING	TB2AG-1104	1	TB2AG-1104	1
-	BRACKET	WA1FA1	2	WA1FA1	2
-	UHMW BUSHING 3/8'' I.D.	TB1AEA	2	TB1AEA	2
-	PIN Ø3/8''x3''LG	WA1FC	2	WA1FC	2
-	COLLAR 3/8''				
20.1	MOUNTING ARM	TB2AGA-1104		TB2AGA-1104	



TIRE DRESSING APPLICATOR, MODEL TB3-CUS999

PUSH BAR AND DRIVER SIDE ARMS SAME LENGTH AS FOR PASSENGER SIDE

ITEM	Description	DRIVER SIDE		PASSENGER SIDE	
		PART NO.	Qty	PART NO.	Qty
21	TIRE WASHER RETRACT KIT	TB2AF	1set	TB2AF	1set
-	REAR MOUNT for Air Cylinder	TB2AGB-1104	1	TB2AGB-1104	1
-	AIR CYLINDER (2'' Bore, 8'' Stroke)	AC2X8-R	1	AC2X8-R	1
-	BALL JOINT ROD END 1/2''-20, female	BJ1/2-20	1	BJ1/2-20	1
-	PIN 1/2''x2''LG (front and rear)	WA1GC	2	WA1GC	2
-	COTTER PIN	CP1/2	2	CP1/2	2
-	JAM NUTS	-	1	-	1
22	AIR PUMPING STATION w/2 FLOJET	APS1-2F			1
-	FLOJET PUMP	APS1F			2
23	APPLICATION MANIFOLD ASSEMBLY	TB2M-CUS999-1013	1	TB2M-CUS999-1013	1
23.1	CLAMP 1/2''				



TIRE DRESSING APPLICATOR, MODEL TB2-CUS999 AIR PUMPING STATION w/2 FLOJET PUMP, Model APS1-2F

Only for NON FOAMING OPTION-APS1-2F

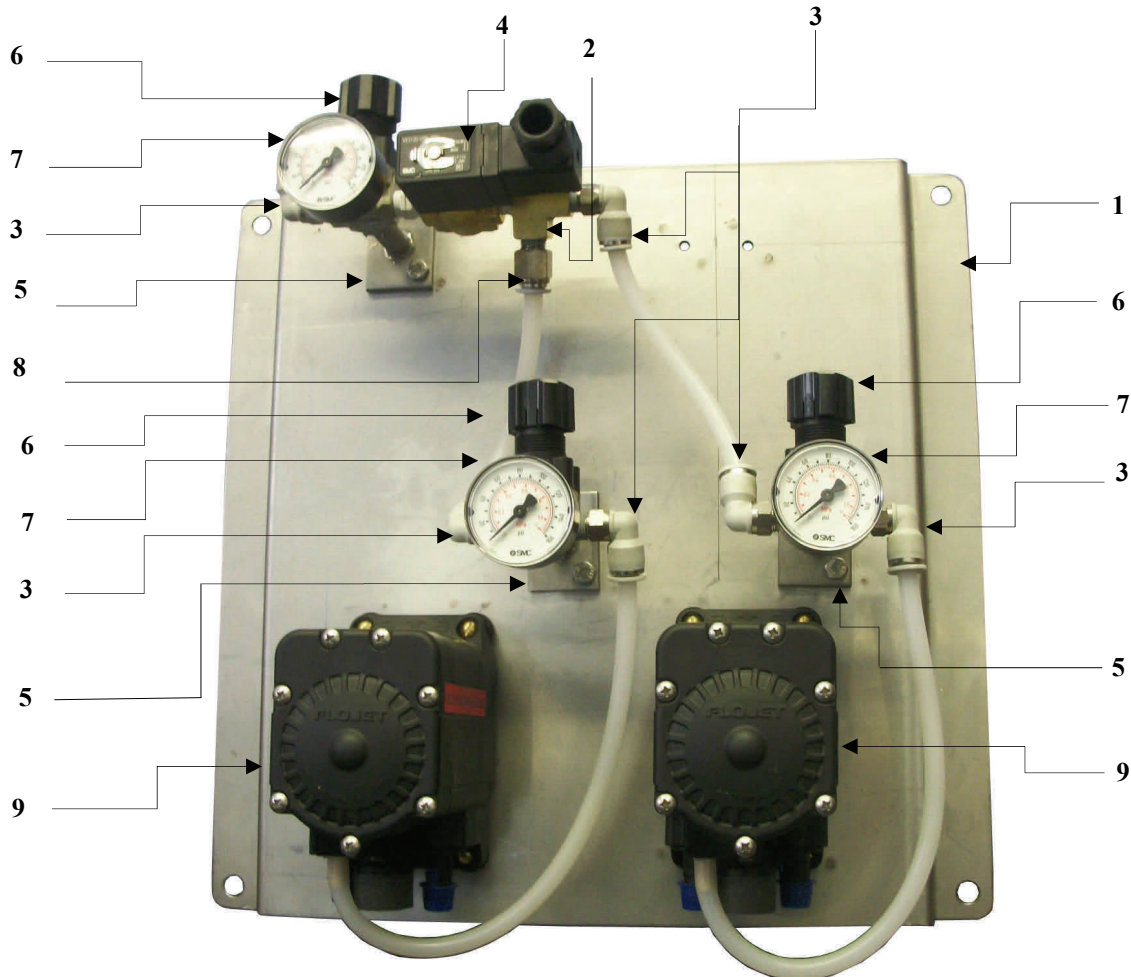

ITEM	DESCRIPTION	PART NO.	QTY.
1	PANEL, PLATE: 16'' x 18'' , STAINLESS STEEL	-	1
2	BRASS TEE 1/4''MxFxFx1/4''NPT	TEEBR025	1
3	AIR PUSH FITTING ELBOW 3/8''x1/4'' NPT	APF3814-EL90	5
4	VALVE ASSEMBLY—SOLENOID 1/4''	APS1SV1_SMC	1
5	STAND OFF BRACKET 1/4	APS1FB	3
6	AIR REGULATOR 1/4''	FRL1-4-R-SMC	3
7	PRESSURE GAUGE 160PSI	SG160ZC	3
8	AIR PUSH FITTING 3/8'' x 1/4'' NPT	APF3814	1
9	FLOJET PUMP SANTO 5.0 GPM	APS1F-S	2

