

THIS DOCUMENT CONTAINS PROPRIETARY AND CONFIDENTIAL DATA OF CLEAN AIR TECHNOLOGIES/EUROVAC, INC. NO DISCLOSURE, REPRODUCTION, OR USE OF ANY PART THEREOF, MAY BE MADE WITHOUT WRITTEN PERMISSION OF THE COMPANY.

# CLEAN AIR TECHNOLOGIES

# EUROVAC

TEL.: 1-800-265-3878

www.eurovac.com

## PRODUCT SPECIFICATIONS

PRODUCT:  
20 HP MULTI-STAGE CENTRIFUGAL EXHAUSTER

PART NO.  
40E-07502030

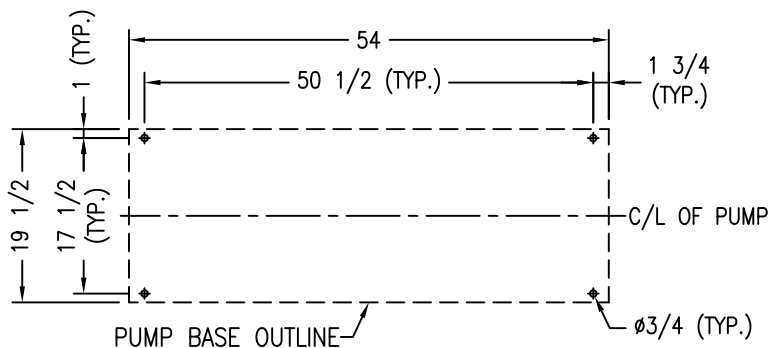
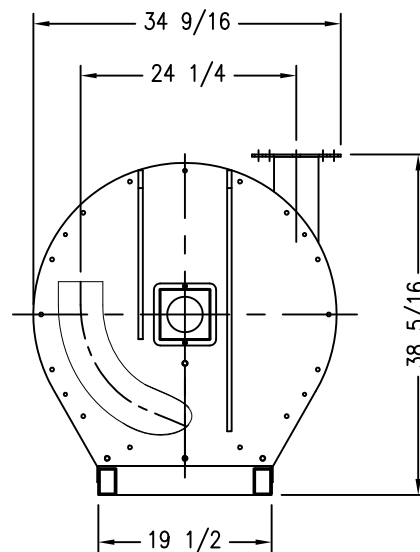
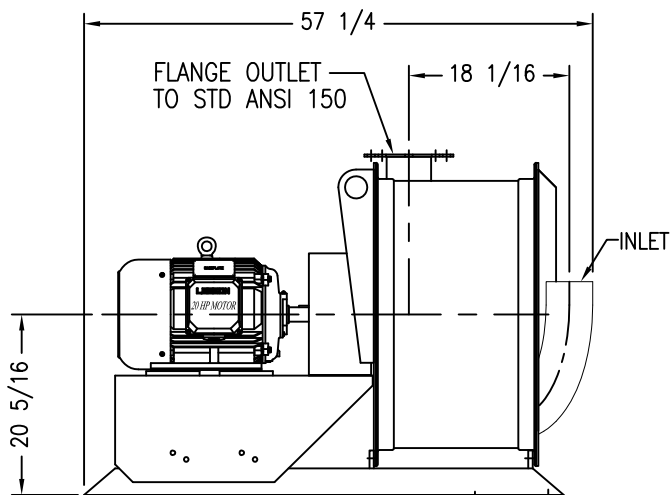

PUMP BASE HOLE LAYOUT

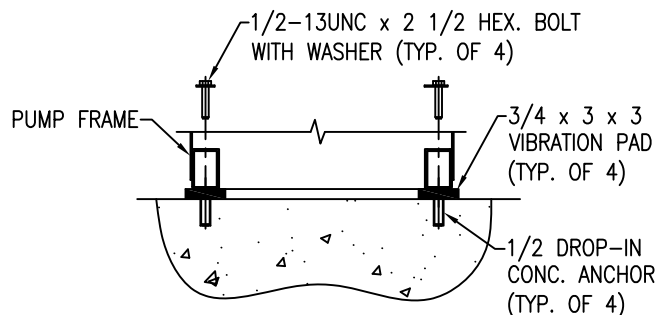

SECTION DETAIL

NOTE: DO NOT TIGHTEN BOLT. WASHER MUST BE ABLE TO SPIN FREELY AFTER INSTALLATION.

CATALOG NUMBER	POWER HP (KW)	MOTOR RPM	MAX VOLUME CFM	VACUUM in Hg (in wg)	VOLT/PHASE/FREQ.	SOUND LEVEL (dBA)	NUMBER OF STAGES	INLET O.D. in (mm)	OUTLET O.D. in (mm)	APPROX. WT. lb (kg)
522A20	20 (15)	3600	470	7.5 (102)	460/3/60	80 @ 3m	5	5 (125)	5 (125)	980 (445)

**NOTES:**

1. ALL DIMENSIONS SHOWN ARE FOR REFERENCE PURPOSES ONLY, NOT FOR CONSTRUCTION USE.
2. HEIGHT OF UNIT DOES NOT INCLUDE VIBRATION ISOLATOR.
3. NO SPECIAL FOUNDATION IS REQUIRED FOR EXHAUSTERS; DO NOT FASTEN DOWN TO CONCRETE FLOOR
4. DO NOT USE SOLID TUBING CONNECTORS AT INLET AND DISCHARGE. USE RUBBER SLEEVES WITH CLAMPS.
5. STANDARD ROTATION IS CW WHEN VIEWED FROM MOTOR END.
6. INLET FURNISHED STANDARD WITH BUTTERFLY THROTTLING VALVE.
7. SPECIFICATIONS SUBJECT TO CHANGE WITHOUT NOTICE.

\*NOTE: ALL DIMENSIONS ARE IN INCHES.

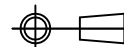

DIMENSIONS AND DESIGN ARE SUBJECT TO CHANGE TO MANUFACTURER'S DISCRETION.